

EXH220 Series

Honeywell Explosion Proof Camera Series

FEATURES

- Explosion proof camera system
- Built-in x25 / x35 zoom camera
- Clear view thanks to Wiper system to remove dust and grime
- IP67 protection degree
- Ex d IIC T6 Certification
- SUS316 material
- Quick & easy installation
- Use with Fixed Mount or Explosion proof Pan / Tilt
- Rugged construction
- Ground and polished, fully tempered plate glass



Model Selection Guide

EXH220 N W-25

System N : NTSC

P : PAL

Wiper W : with Wiper

: without Wiper

Zoom Camera 25 : x 25

35 : x 35

SPECIFICATIONS

Ex-proof Housing Part

Model No.	EXH220NW -25/35	EXH220PW -25/35	EXH220N -25/35	EXH220P -25/35
Front Window	Ground and polished, fully tempered plate glass			
Construction	SUS 316			
Protection Degree	IP67			
Wiper Angle	50°(±25°) movement		No wiper	
Regulatory	IECEX: Ex d IIC T6 Emissions: CE/FCC Class A Immunity: CE Class A			
Weight	Approx. 7.6 kg			
Operating Temp.	-10°F ~ 120°F (-23°C ~ 48°C)			
Power Requirement	220V AC: Wiper Motor input power 12 V DC: Main camera DC Power			

Camera Part

Model No.	EXH220N(W) -25	EXH220P(W) -25	EXH220N(W) -35	EXH220P(W) -35
Pick-up Device	1/4" IT Ex-view CCD		1/4" Sony Double Scan CCD (Ex-View CCD)	
Total Pixels	410,000	470,000	410,000	470,000
Effective Pixels	380,000	440,000	380,000	440,000
Scanning System	2:1 Interlace			
Lens	Optical x25 Zoom, f = 3.8~95mm, F1.6(WIDE) ~ F3.7(TELE)		Optical x35 Zoom, f = 3.6~126mm, F1.65(WIDE) ~ F4.2(TELE)	
Digital Zoom Ratio	x26 ~ x250 can be adjustable		x36 ~ x90 can be adjustable	
Sync System	Internal / line lock/ VD pulse lock (AutoDetect)			
H. Resolution	480 TV lines	470 TV lines	530 TV Lines	
S/N Ratio	more than 50 dB (AGC OFF)			
Min. illuminance	0.8 lx (30IRE) ; 0.05 lx (Night OFF) ; 0.008 lx (128 fields, Night OFF) ; 0.0005 lx(128 fields, Night ON)		0.5 lx (30IRE) ; 0.05 lx (Night OFF) ; 0.0005 lx (510 fields, Night OFF) ; 0.00001 lx (510 fields, Night ON)	
Focus Mode	Auto / Manual / Oneshot			
Brightness	0 ~ 99 adjustable			
Shutter Speed	1/60~1/10,000	1/50~/10,000	1/60 ~ 1/50,000	1/60~1/50,000
Field Integration	x2 ~ x128 adjustable		x2 ~ x510 adjustable	
Mirror	Horizontal / Vertical / FLIP(Horizontal Mirror + Vertical Mirror)			
Day & Night Mode	AUTO / ON / OFF (CDS Sensor ON/OFF)			
Privacy Zone	ON (Max 8 area) / OFF			
AGC	ON (8 ~ 38dB) / OFF			
White Balance	ATW / AWC / OnePush / Indoor / Outdoor / MWB		AUTO(ATW, AWC) / OneShot / Indoor / Outdoor / Manual /AWB	
BLC	ON / OFF / AUTO (5 regions)		ON / OFF / H.BLC	
BMB	ON (16 blocks) / OFF		-	
WDR	-		ON / OFF	
Remote Control	RS-485			

Product List

EXH220N-25	Explosion Proof Housing Camera built in 25x Zoom, NTSC
EXH220P-25	Explosion Proof Housing Camera built in 25x Zoom, PAL
EXH220N-35	Explosion Proof Housing Camera built in 35x Zoom, NTSC
EXH220P-35	Explosion Proof Housing Camera built in 35x Zoom, PAL
EXH220NW-25	Explosion Proof Housing Camera built in 25x Zoom, NTSC, with Wiper
EXH220PW-25	Explosion Proof Housing Camera built in 25x Zoom, PAL, with Wiper
EXH220NW-35	Explosion Proof Housing Camera built in 35x Zoom, NTSC, with Wiper
EXH220PW-35	Explosion Proof Housing Camera built in 35x Zoom, PAL, with Wiper

Related Products

EXB220-W	Wall Mount Bracket
EXB220-C	Ceiling Mount Bracket

Dimensions (mm)

Zoom Camera Housing

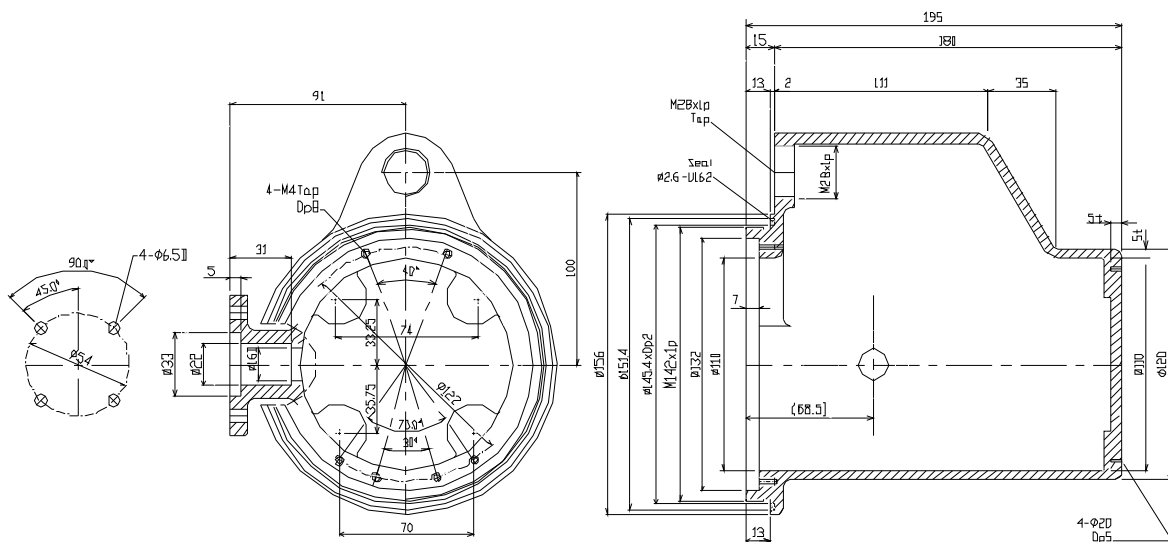

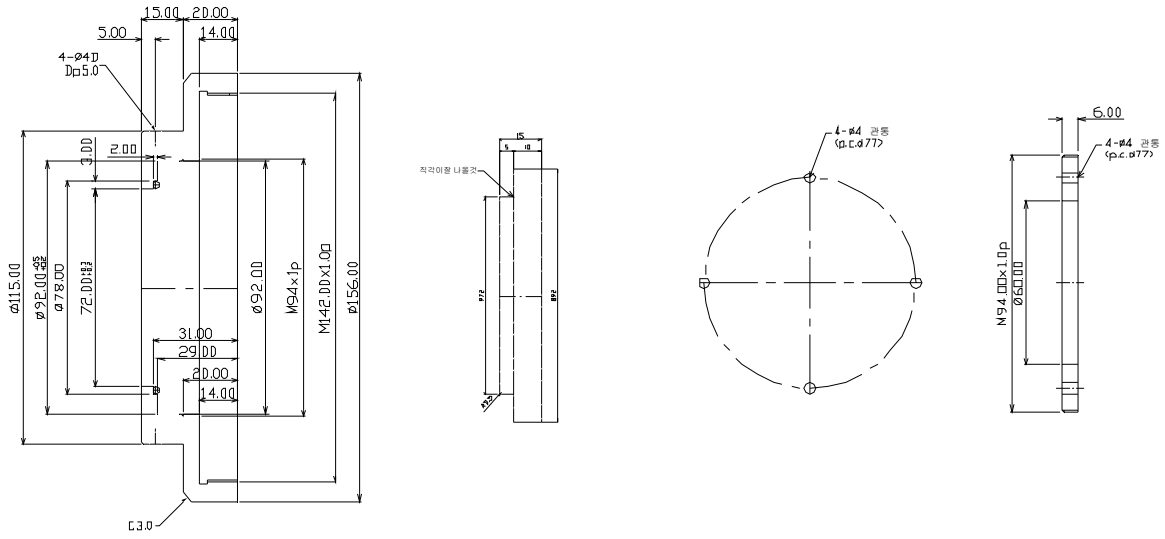

Ceiling Mount Bracket

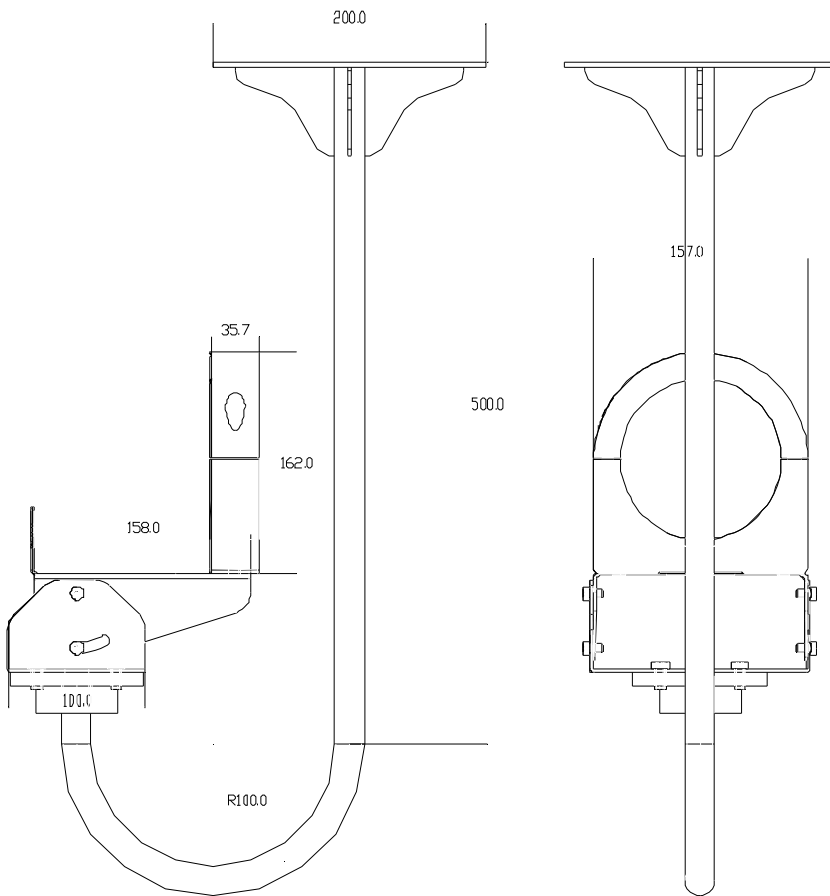

Wall Mount Bracket

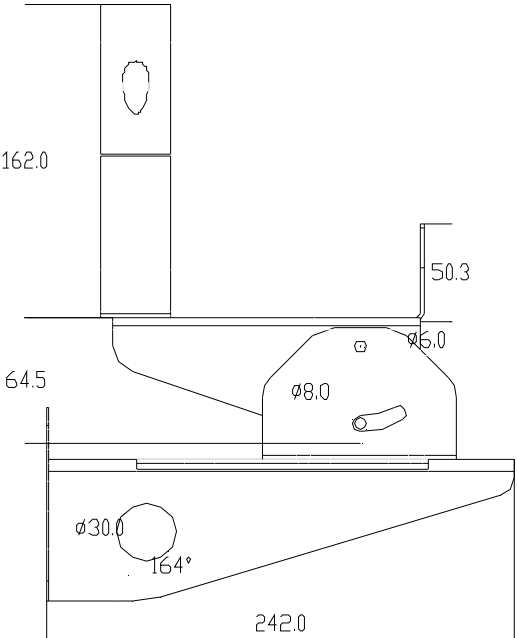
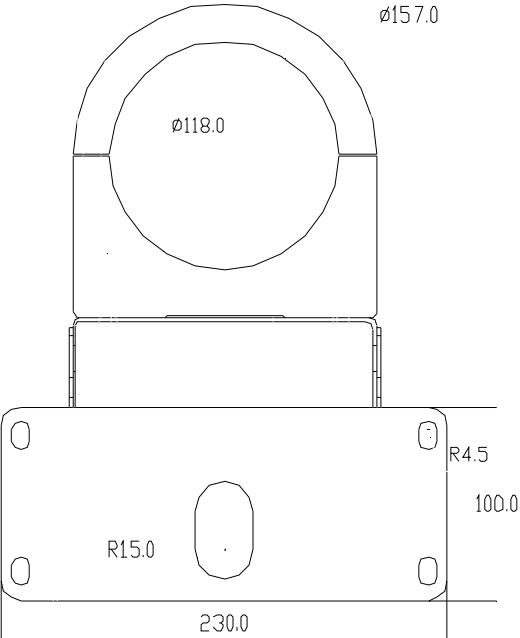

For more information:

Asia Pacific Headquarters:
Australia
China
Hong Kong

Tel: (86) 21-5257 4568
Tel: (61) 2-8837 9300
Tel: (86) 755-2518 1226
Tel: (852) 2405 2323

India
Korea
Singapore
Taiwan

Tel: (91) 124 4105671
Tel: (82) 2-799 6109
Tel: (65) 6333 9563
Tel: (886) 2-2245 1000

www.asia.security.honeywell.com
security.ap@honeywell.com

Automation & Control Solutions

Honeywell Security - Asia Pacific
Honeywell International Inc.
www.security.honeywell.com

May 2008

© 2008 Honeywell International Inc.

Honeywell